

DETAILED MEASUREMENTS

FRENCH BALCONY WITH MOUNTING POINTS

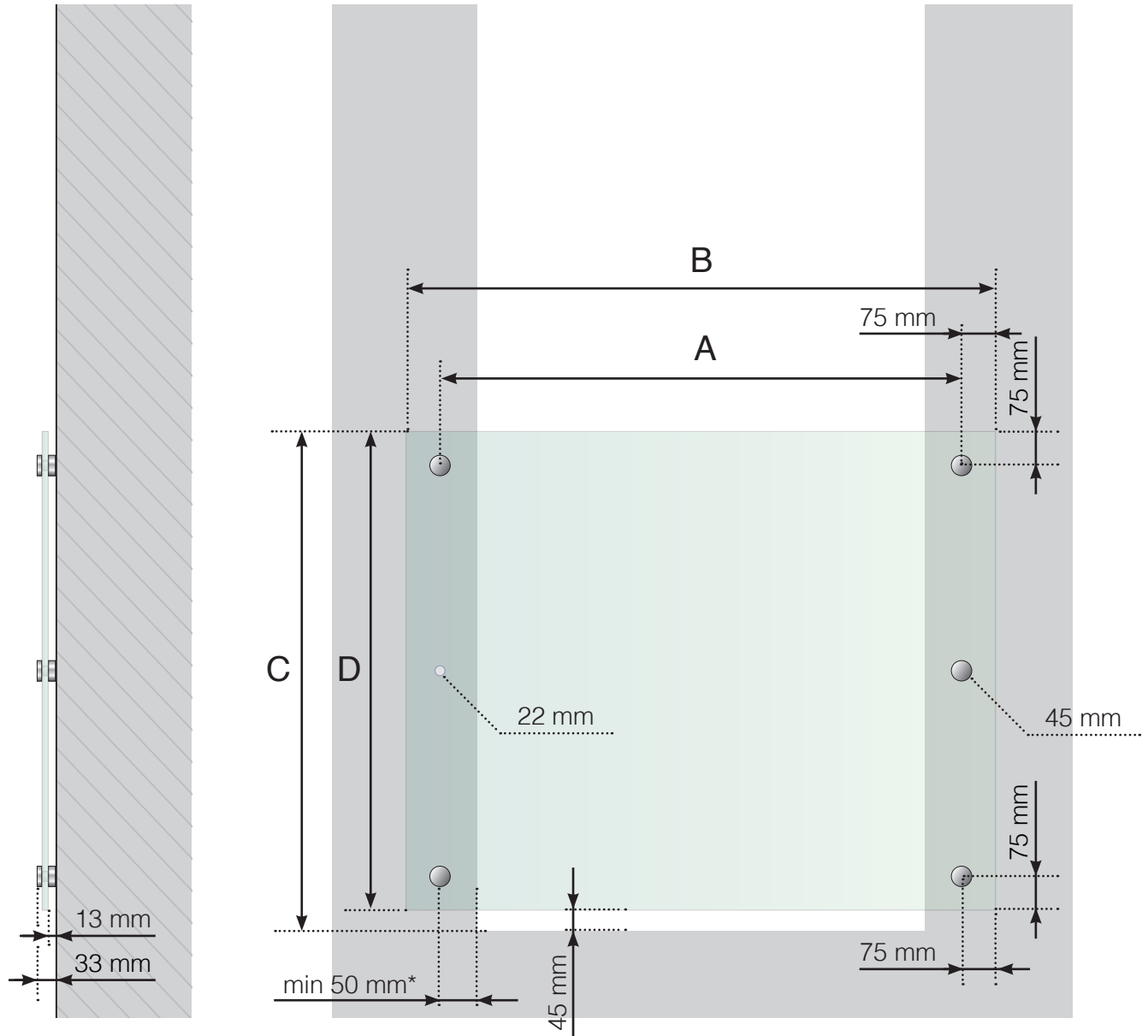

A - Support c/c dimensions

B - The width of the glass depends on the c/c measurements of the attachment

C - Total height of the railing

D - Glass height

* When attaching to brick or concrete, fasten the vertical support at least 50 mm, and ideally 75 mm, from the wall edge.

Please note that the drawings are not to scale

© Räckesbutiken Sweden AB - www.balustradestore.eu

2022-10-10 v.1.0

DETAILED MEASUREMENTS

FRENCH BALCONY WITH MOUNTING POINTS AND AN ALUMINIUM CROSSBAR

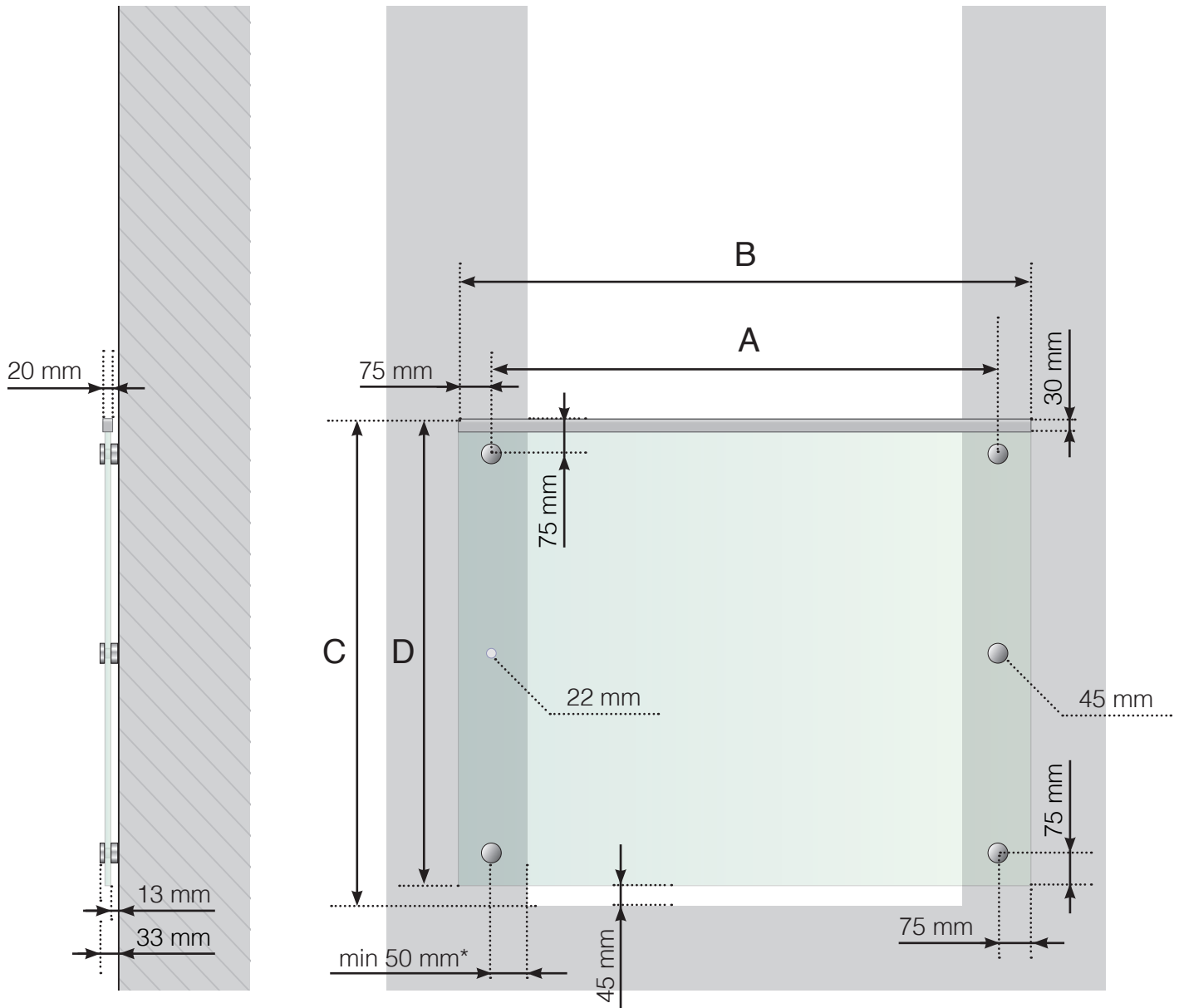

A - Support c/c dimensions

B - The width of the glass depends on the c/c measurements of the attachment

C - Total height of the railing

D - Glass height

* When attaching to brick or concrete, fasten the vertical support at least 50 mm, and ideally 75 mm, from the wall edge.

Please note that the drawings are not to scale

© Räckesbutiken Sweden AB - www.balustradestore.eu

2022-10-10 v.1.0